

Device Parameter

Working Voltage: DC 12V
 Working Current: Non-loaded <200mA
 Working Temperature: -20°C - 50°C (-4°F - 122°F)
 Working Humidity: 10% - 90%
 Power Consumption: <3W
 Size: 85x157x20mm (3.35x6.18x0.79in.)
 Communication Mode: TCP/IP
 Communication Rate: 10/100M (TCP/IP)
 Extension Communication: RS485
 Users Capacity: 20,000
 Records Capacity: 70,000
 Max. Doors: 2
 Dry Contact Input: 6
 Dry Contact Output: 3
 Access Group: 200 Groups
 Default IP Address: 192.168.0.245
 Default Communication Password: NULL

IMPORTANT: These access control panels (Version 2.0) are only compatible with access control panels (Version 2.0) and with the Titan VSAccess software. They are not compatible with access control panels (Version 1.0) nor with VSAccess software.



Commercial Access Control VIS-AXESS-1D-DLX-PCB

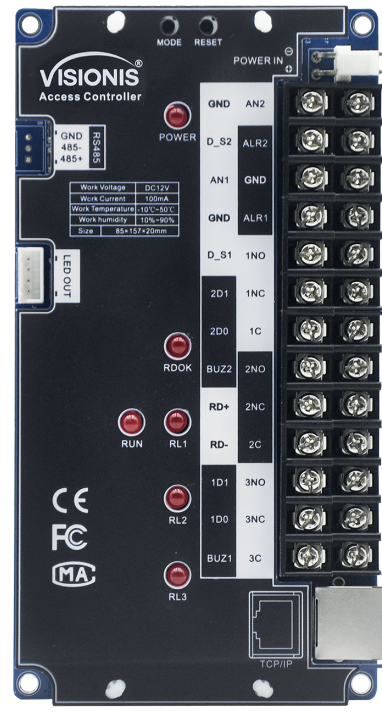

User Guide



www.visionistech.com

Basic Function

- First card open
- Multi-card open
- Anti-passback
- Multi-door interlock
- Card, password, card+password, card or password open mode
- Different time different open mode
- Transmission encryption setup
- Self-checking function
- Remote control
- Wiegand format can be self-defined
- Add card without software
- Multi-channel connection (max. 3 channels)
- Real-time events active or passive upload
- Arm/disarm by card
- Arm/disarm by software
- Relieve alarm by software
- Multi-event linkage alarm
- One event related to multi-relay trigger
- Alarm delay turn off
- Capacity can be expanded
- Self-defined door lock relay
- Self-defined control door quantity
- Door latch mode
- Active door normal open mode by card
- Timed automatic normal open mode
- Timed invalid for exit button
- Normal open time
- Normal open holiday forbidden schedule
- Access time schedule
- Forbid access holiday schedule
- Door lock delay setup
- Access group setup
- Threaten code setup
- Force open/close door
- Open door by software
- Relieve normal open by card
- Relieve card and card valid date setup
- Expand RS485 communication
- Real-time monitoring door and relay state

Wiring Introduction

Wiring Position	Wire Model	Remark
Power Supply - Access Controller	RVV2*1.0	Distance < 100M
Access Controller - Reader	RVV4*0.5	Distance 60M, max. can not over 100M.
Access Controller - Electric Lock	RVV4*1.0 (Door-magnet feedback)	Distance < 150M
Access Controller - Exit Button	RVV2*0.5	Distance < 200M
Access Controller - IR Alarm	RVV2*1.0	Distance < 200M
Access Controller - Sound-light Alarm	RVV2*1.0	Distance < 150M
RS485 Communication Cable	RVV2*1.0	Distance < 1000M, shield layer connect to ground
TCP/IP Communication Cable	CAT-5	Distance < 100M

Connection

I/O	Device	Standard	Quantity	Setup
Input	Reader	Wiegand 26-40	2	as function
Output	Electric Lock	Switch Signal	1/2	as doors
Input	Door-magnet	Switch Signal	1/2	Support
Output	Sound-light alarm	Switch Signal	1/2	
Input	IR Sensor/Smoke Sensor/Others	Switch Signal	2	
Input	Exit button	Switch Signal	1/2	Support
Input	RS485 device	Communication	1	

LED&Button Instruction

LED	RL1	RL2	RL3
One-door	Lock1	Magnet Alarm1	Alarm Output1
Two-door	Lock1	Lock2	Magnet Alarm1

- Power: 12V power LED
- RUN: Device run LED
- RDOK: Read card status LED
- 2DOOR: The status LED of 2 doors
- RDOK + RUN: Device enter online upgrade mode.
- RESET Key: It is used to reboot device and clear communication password. After power off, power on device again and press RESET button for 3 seconds, then you can clear communication password

Disclaimer

The document provides information according to products specification. Visionis does not undertake any type of guarantee, express or implied warranties, including any implied merchantability, specific purposes or the infringement. The information in the document are changed without prior notice. Visionis and its associated sales agents special statement does not assume the result of the use of Visionis equipment of any and all direct, indirect, special, in general, by chance, inevitably, punitive damages. Any user's improper operation or use of the environment problem caused by direct or indirect losses, user pays full responsibility, equipment manufacturers and related sales agents does not undertake any responsibility.

Wiring Diagram of Access Controller

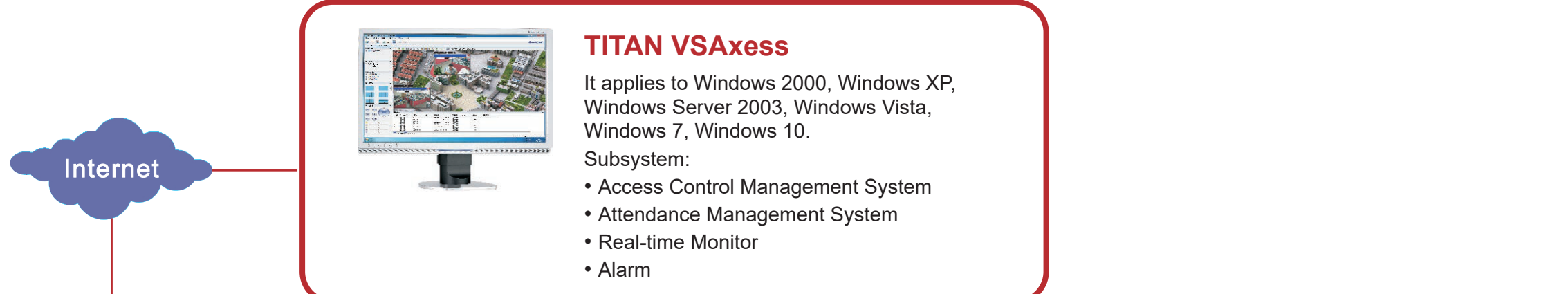

Second Row Terminal

First Row Terminal

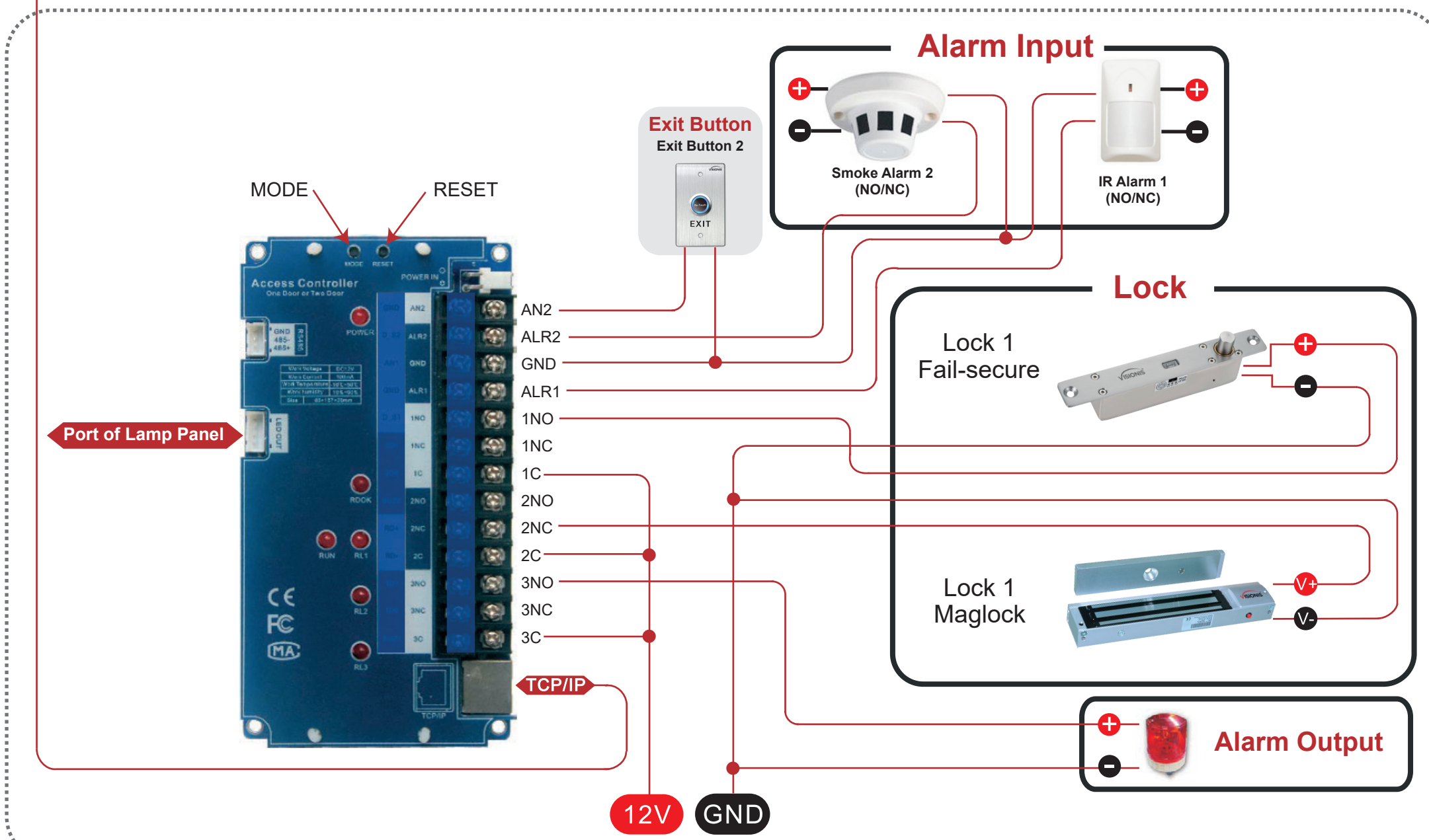
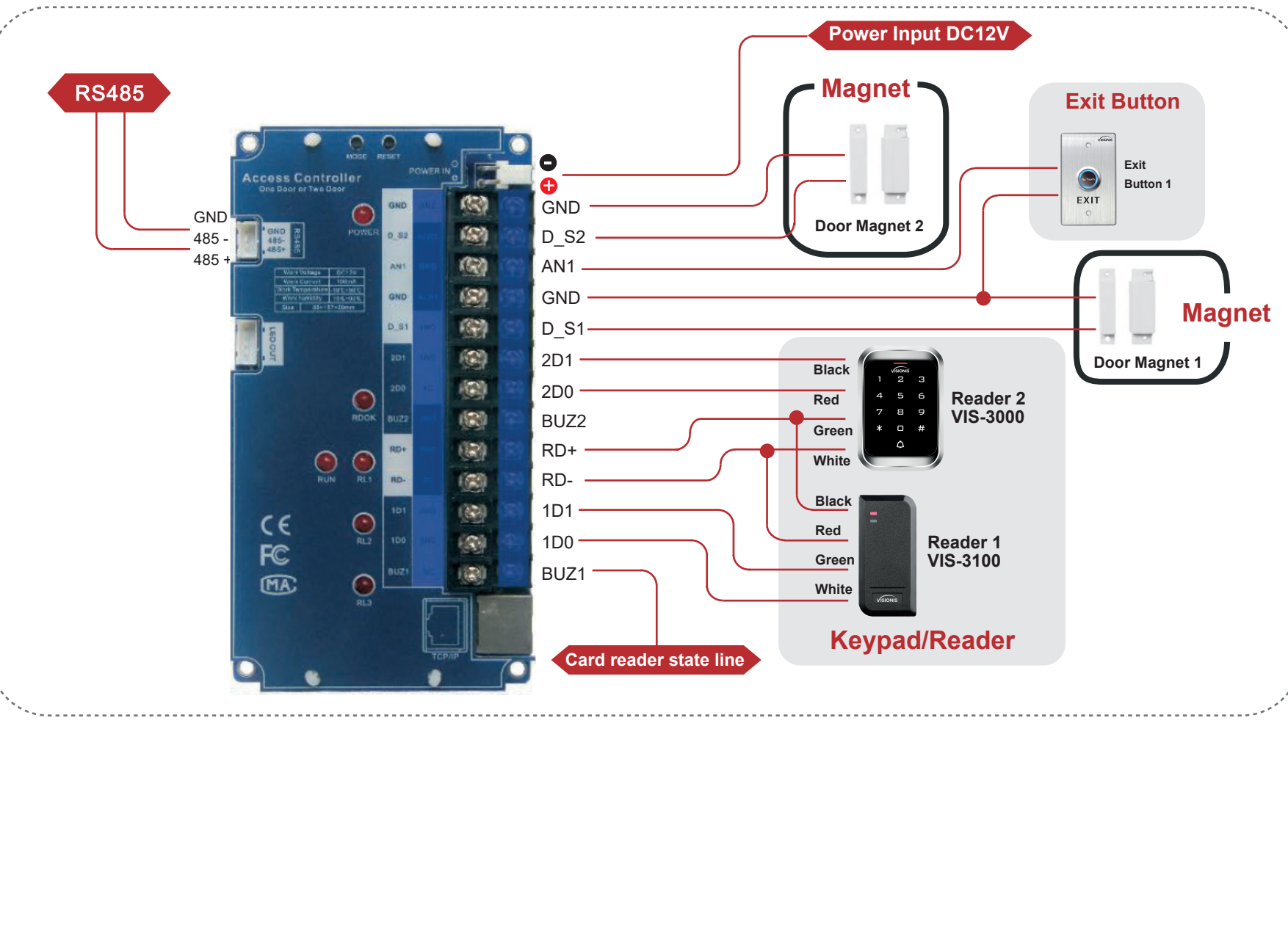

Quick Start

1. Search Controller
 Notice: Search function is only valid in the same LAN, as adopt UDP communication protocol, across gateway will forbid communication.
 Notice: Once installed the Titan VSAccess Login information is: Username: Administrator Password: There is no default Password. Just click OK and you can login. You can set a Password under "Platform" and "Change password".

2. Add Controller
 Notice: 1. Controller IP must be the same as you set.
 2. Controller model must be the same as device type. You can detect controller and check the device type in task report.
 3. Usually we can use ping command to test the device physical connection.
 4. Controller Address is only valid when use MS series controller or TCP/IP to RS485 connector, otherwise, the default is 0.
 5. Wrong time may no access and incorrect access record. Please adjust the time.
 6. Initialize the controller will clear the device records, please make sure the records are saved.

3. Add Card
 Notice: 1. Three ways to add card, card distributor add card, controller add card and add card manually. Card distributor add card need to choose our card distributor. 2. Same card can only add once.
 3. Please note that delete card will clear the card related to employee.

4. Add Employee
 Notice: 1. If there are employees with the same name, you can separate them by code. Code is unique.
 2. Card number is decimal number.
 3. Default administrator access group can pass anywhere anytime, it is the top authority.
 4. Each employee can access with a separate 6-digit password.
 5. Import from Excel can quick register employees.

5. Download Setup
 Notice: 1. Three download setup ways: Download setup, download all setups, smart download. Download setup refer to current device, download all setups and smart download refer to all devices. Smart download only download updated contents. Other two is download all setups.
 2. When adopt smart download and download all setups, if there is a device offline, it will prompts error.
 3. Default administrator access group can pass anywhere anytime, it is the top authority.

Important Notices

- Power off when wiring.
- Power on when wiring OK.
- Power supply output current must 1.3 times bigger than device work current.
- Lock should better use a separate power.
- All devices must be connected to common GND.
- RS485 communication must use hand to hand connection.
- Between different reader should have 10cm to avoid interference.
- All it is a current weak system, strong and weak isolation must be done.
- The wiring of strong and weak should not be parallel and distance at least 20cm.
- RS485 line should connect the cable shield to GND to avoid interference.
- When RS485 line interface more devices, user can add a 120Ω resistance between 485+ and 485- of last device.
- Reader can not install on the metal directly.

The manual is a quick start for system, the user can refer to software help file or other technical files for details.